

CHANGSHA TAIHE ELECTRONIC EQUIPMENT CO.,LTD.

Pressure Sensor | Temperature Sensor | Liquid Level Sensor | Load Cell | Smart Instruments

Position sensor | Torque | Internet of Things



16

Years of experience in sensor R&D,
manufacturing and production

Provide one-stop customization services
for various sensors

PPM-T230E-230A

Explosion-proof pressure transmitter

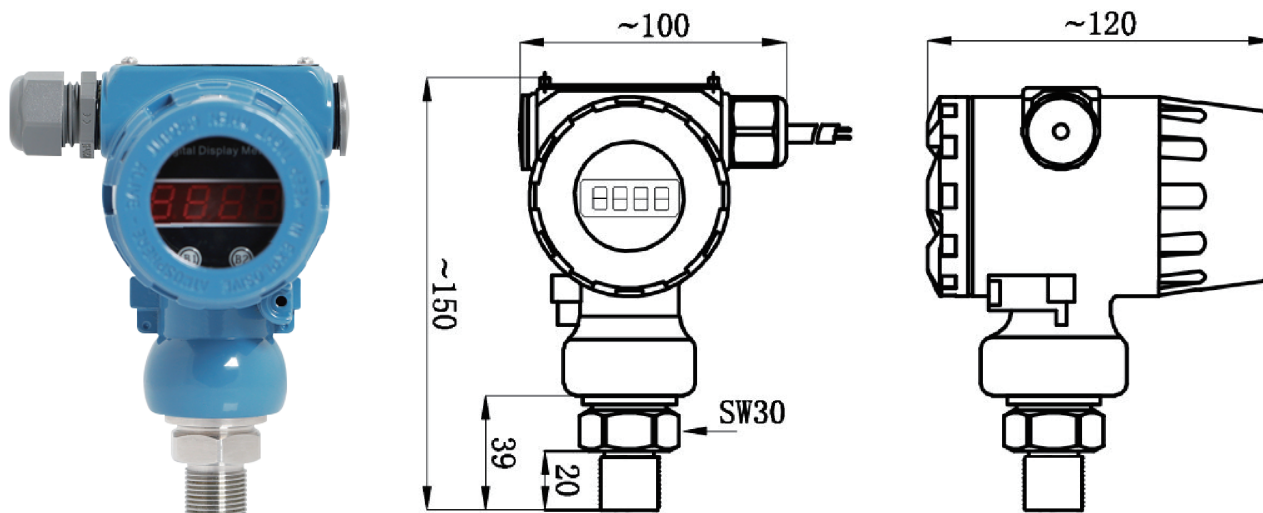

Product Introduction

PPM-T230E-230 series is our company's product specially designed for high-explosive hazardous places or working conditions. It uses imported premium materials and advanced MEMS technology to process into an integrated pressure core, which is equipped with a precision processing circuit. The temperature signal can be compensated, and it can output 4-20mA, 0-5VDC, 1-5VDC, 0-10VDC standard signals. It has the characteristics of high accuracy, anti-interference, strong overload and impact ability, moisture resistance and long-term stability. Time directly measures -196°C liquid, no need to extend the tube, making the measured value true and reliable. A variety of pressure interfaces and electrical interfaces are available for customers to choose to meet the pressure measurement of various industrial processes.

Applications

LNG cryogenic pressure measurement, CNG pressure measurement natural gas control system, Natural gas compressors, dispensers, oil well platforms, wellhead pressure equipment, BOP, pipeline equipment, mines, oil tanks, oil storage and transportation monitoring, Petrochemical equipment, oil refining, oxygen transmission systems and pipelines, hydrogen equipment, Power stations, boilers, thermal power units, petrochemicals, environmental protection, air pressure, light industry, machinery, Metallurgy and other pressure measurement environments with explosion-proof requirements.

Technical Parameters

Measured Medium	Liquid, gas
Pressure Type	Gauge pressure or custom
Pressure Range	0~0.1bar...2000bar
Power Supply	9~36VDC
Output Signal	4~20mA
Mounting Thread	M20×1.5,G1/2,1/2NPT,1/4NPT,G1/4 other customized
Electrical Interface	M20×1.5,G1/2
Non-linearity	≤ 0.2% FS
Repeatability	0.2% FS
Accuracy	0.2% FS,0.5% FS
Long-term Stability	0.25% FS/year
Working Medium Temperature	-40℃~+85℃,-196℃~+85℃
Working Environment Temperature	-40℃~+75℃

Definition of Wiring

Direct outgoing			
		2-wire system	3-wire system
	Power supply	red	red
	Negative power	black	black
	Signal positive	—	green

CONTACT US

www.csppmSensor.com

Address: No. 188, Huanbao Road, Yuhua Zone, Changsha, Hunan, China

E-mail: info@csppm.com

Mobile | Wechat | WhatsApp: +86 19118913383